



**Key**

Order Limits

The Infrastructure Planning (Applications: Prescribed Forms and Procedure) Regulations 2009 – Regulation 5(2)(a)

REV	DATE	BY	DESCRIPTION	CHK	APP
01	24/10/2019	YH	FIRST ISSUE	TF	LB

DRAWING STATUS: **FINAL**



WSP House, 70 Chancery Lane, London, WC2A 1AF,  
T+ 44 (0) 020 7314 5000  
wsp.com



PROJECT: **AQUIND Interconnector**

TITLE: **Low Resolution -  
Figure 24.2 Key plan  
Sheet 0 of 15**

SCALE AT A1 1:42,336	CHECKED: TF	APPROVED: LB
PROJECT NO: EN020022	DESIGNED: JT	DRAWN: YH
DRAWING NO: <b>EN020022-ES-24.2-Sheet0</b>		REV.NO: 01

Reproduced from Ordnance Survey digital map data © Crown copyright 2019. All rights reserved.



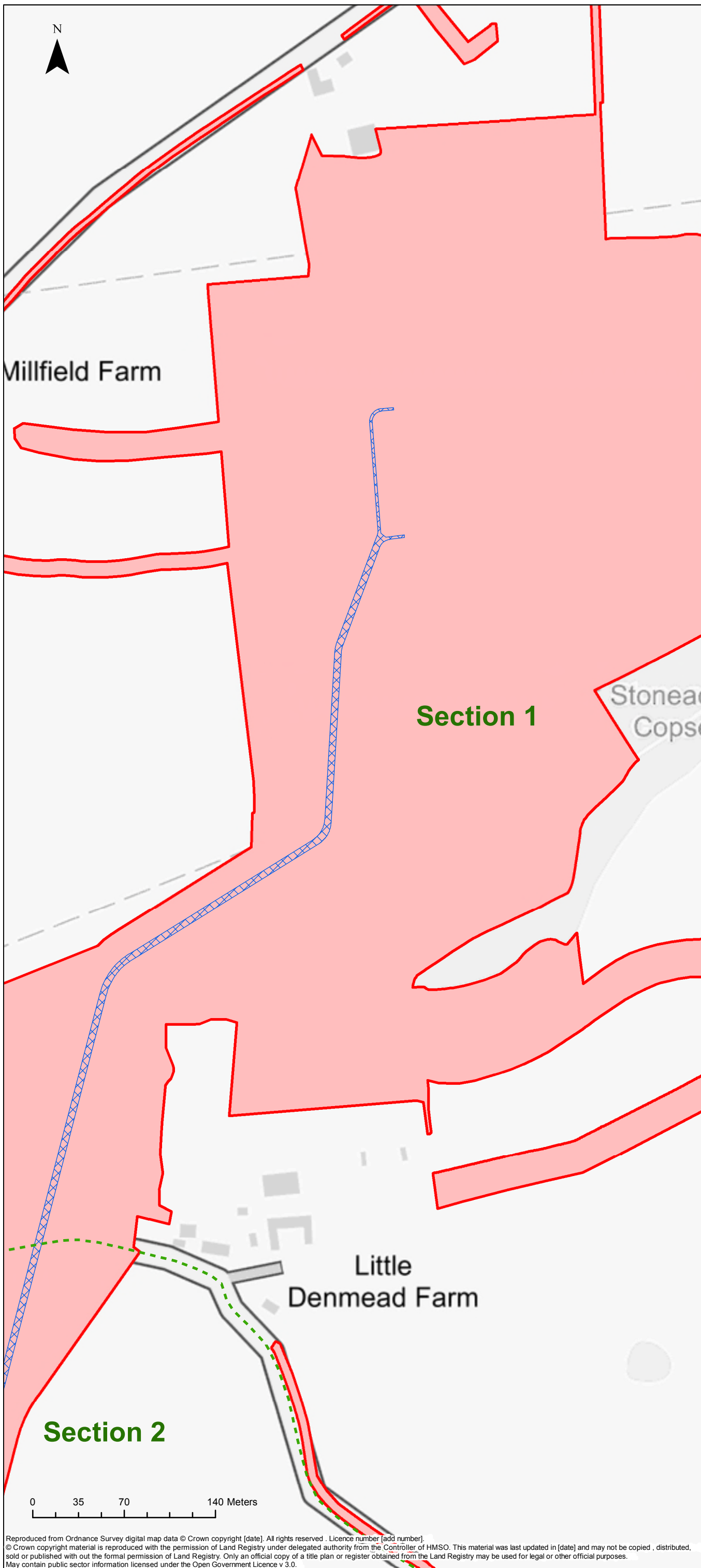

### Key

- Order Limits
- Order Limits Section Breaks
- Trenching - illustrative alignment

**N.B. The trenching, HDD and joint bay locations/alignments are for illustrative purposes only to provide context to the noise and vibration assessment. The illustration represents a scenario of how the cable route could be laid within the cable corridor, to facilitate a reasonable worst case noise and vibration assessment. The precise alignment and locations of the cable route, HDD sites and joint bays are yet to be determined.**

The Infrastructure Planning (Applications: Prescribed Forms and Procedure) Regulations 2009 – Regulation 5(2)(a)

01	24/10/2019	YH	FIRST ISSUE	TF	LB
REV	DATE	BY	DESCRIPTION	CHK	APP

DRAWING STATUS: **FINAL**

WSP House, 70 Chancery Lane, London, WC2A 1AF,  
T+ 44 (0) 020 7314 5000  
wsp.com

CLIENT:

PROJECT:  
**AQUIND Interconnector**

TITLE:  
**Low Resolution - Figure 24.2  
Illustrative cable route, HDD sites and  
joint bays for noise and vibration assessment  
Sheet 1 of 15**

SCALE AT A1 1:3,000	CHECKED: TF	APPROVED: LB	
PROJECT NO: EN020022	DESIGNED: TF	DRAWN: YH	DATE: 23/10/2019

DRAWING NO: <b>EN020022-ES-24.2-Sheet1</b>	REV.NO. 01
---	---------------

Reproduced from Ordnance Survey digital map data © Crown copyright [date]. All rights reserved. Licence number [add number].  
© Crown copyright material is reproduced with the permission of Land Registry under delegated authority from the Controller of HMSO. This material was last updated in [date] and may not be copied, distributed, sold or published without the formal permission of Land Registry. Only an official copy of a title plan or register obtained from the Land Registry may be used for legal or other official purposes.  
May contain public sector information licensed under the Open Government Licence v 3.0.

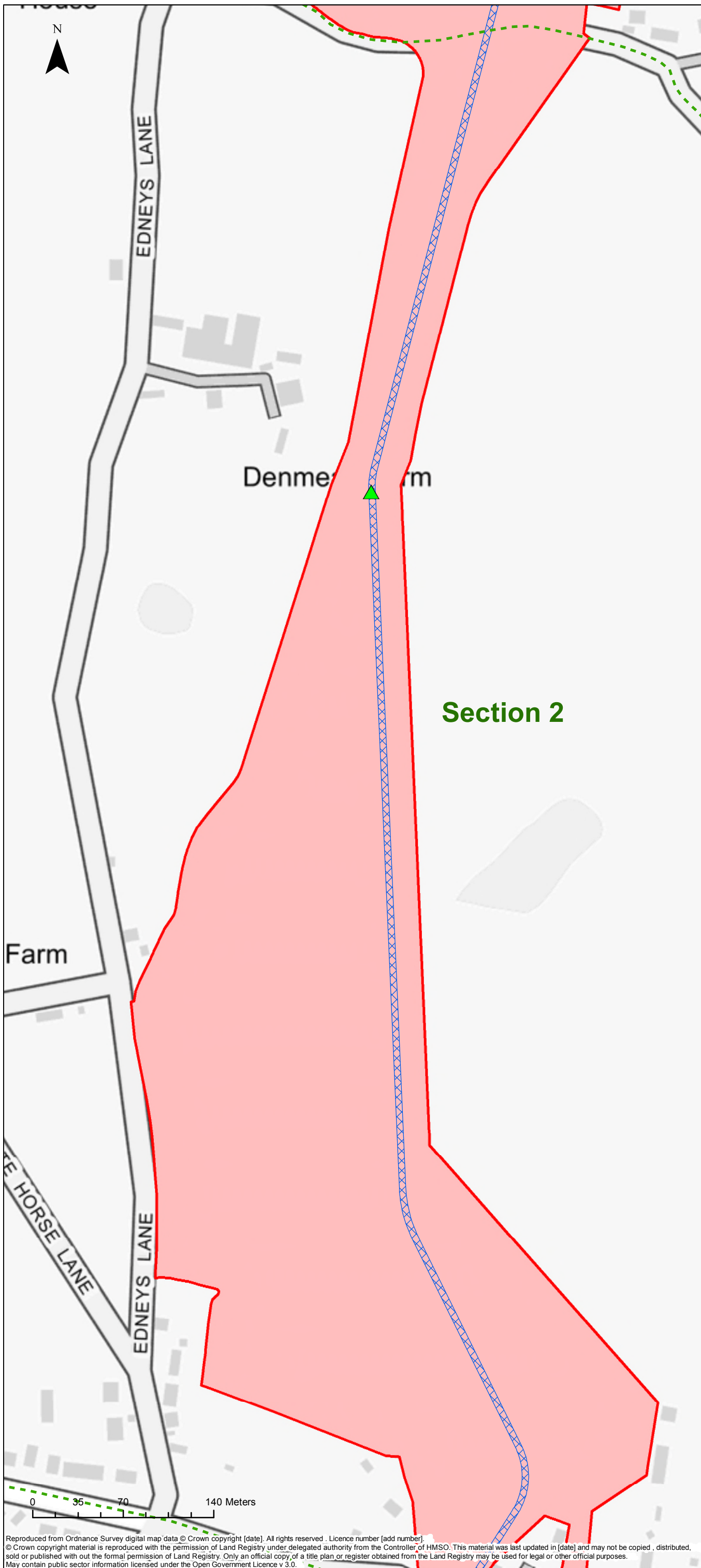

**Key**

- Order Limits
- Order Limits Section Breaks
- Trenching - illustrative alignment
- JB1/2- illustrative location

**N.B. The trenching, HDD and joint bay locations/alignments are for illustrative purposes only to provide context to the noise and vibration assessment. The illustration represents a scenario of how the cable route could be laid within the cable corridor, to facilitate a reasonable worst case noise and vibration assessment. The precise alignment and locations of the cable route, HDD sites and joint bays are yet to be determined.**

The Infrastructure Planning (Applications: Prescribed Forms and Procedure) Regulations 2009 – Regulation 5(2)(a)

REV	DATE	BY	DESCRIPTION	CHK	APP
01	24/10/2019	YH	FIRST ISSUE	TF	LB

DRAWING STATUS: **FINAL**



WSP House, 70 Chancery Lane, London, WC2A 1AF,  
T+ 44 (0) 020 7314 5000  
wsp.com

CLIENT:



PROJECT:  
**AQUIND Interconnector**

TITLE:  
**Low Resolution - Figure 24.2  
Illustrative cable route, HDD sites and  
joint bays for noise and vibration assessment  
Sheet 2 of 15**

SCALE AT A1 1:3,030	CHECKED: TF	APPROVED: LB
------------------------	----------------	-----------------

PROJECT NO: EN020022	DESIGNED: TF	DRAWN: YH	DATE: 23/10/2019
-------------------------	-----------------	--------------	---------------------

DRAWING NO: <b>EN020022-ES-24.2-Sheet2</b>	REV.NO. 01
---	---------------

© WSP UK Ltd

Reproduced from Ordnance Survey digital map data © Crown copyright [date]. All rights reserved. Licence number [add number].  
© Crown copyright material is reproduced with the permission of Land Registry under delegated authority from the Controller of HMSO. This material was last updated in [date] and may not be copied, distributed, sold or published without the formal permission of Land Registry. Only an official copy of a title plan or register obtained from the Land Registry may be used for legal or other official purposes.  
May contain public sector information licensed under the Open Government Licence v 3.0.



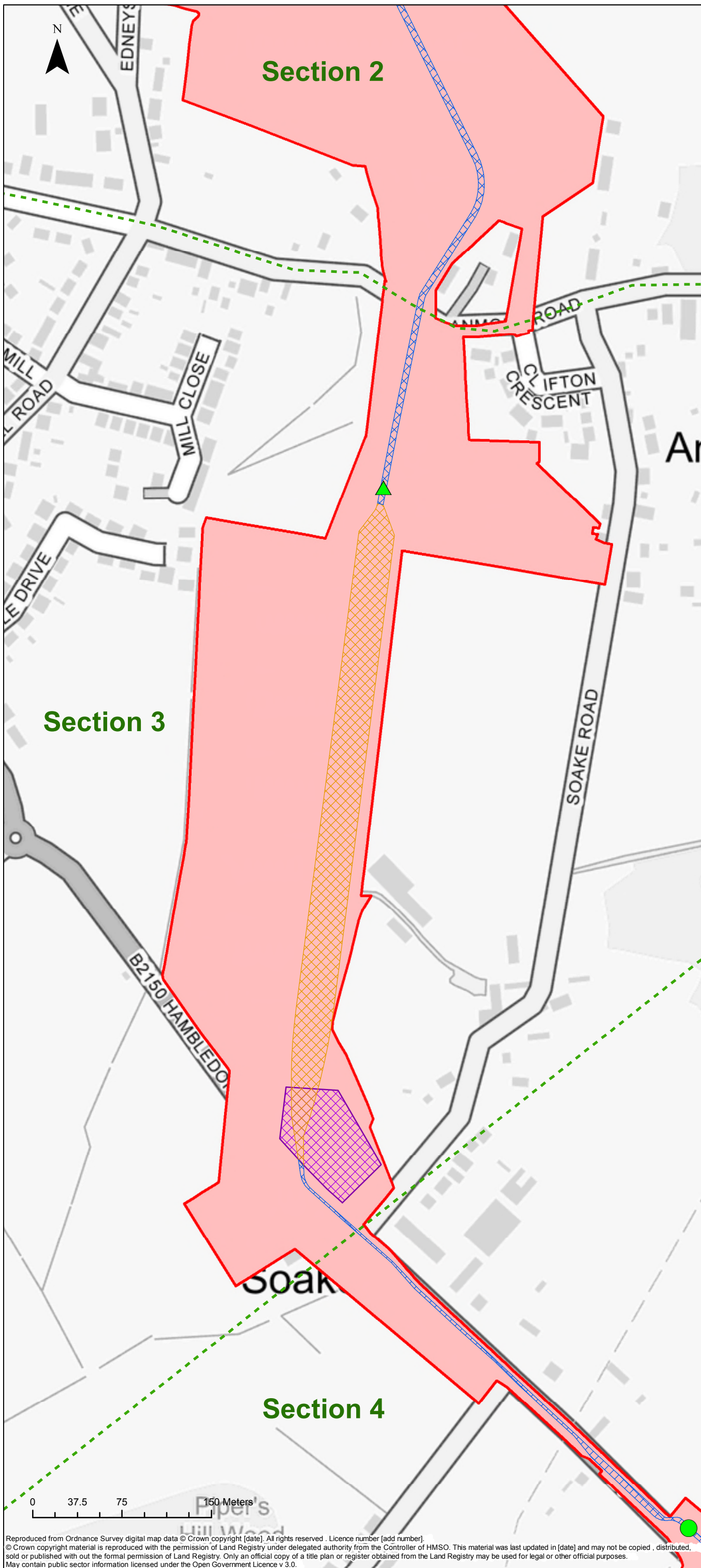

### Key

- Order Limits
- Order Limits Section Breaks
- Trenching - illustrative alignment
- HDD-5 - illustrative drilling alignment
- HDD-5 - illustrative site compound
- JB2/3 - illustrative location
- JB3/4 - illustrative location

**N.B. The trenching, HDD and joint bay locations/alignments are for illustrative purposes only to provide context to the noise and vibration assessment. The illustration represents a scenario of how the cable route could be laid within the cable corridor, to facilitate a reasonable worst case noise and vibration assessment. The precise alignment and locations of the cable route, HDD sites and joint bays are yet to be determined.**

The Infrastructure Planning (Applications: Prescribed Forms and Procedure) Regulations 2009 – Regulation 5(2)(a)

01	24/10/2019	YH	FIRST ISSUE	TF	LB
REV	DATE	BY	DESCRIPTION	CHK	APP

DRAWING STATUS: **FINAL**



WSP House, 70 Chancery Lane, London, WC2A 1AF,  
T+ 44 (0) 020 7314 5000  
wsp.com

CLIENT:



PROJECT: **AQUIND Interconnector**

TITLE: **Low Resolution - Figure 24.2  
Illustrative cable route, HDD sites and  
joint bays for noise and vibration assessment  
Sheet 3 of 15**

SCALE AT A1 1:3,290	CHECKED: TF	APPROVED: LB
------------------------	----------------	-----------------

PROJECT NO: EN020022	DESIGNED: TF	DRAWN: YH	DATE: 23/10/2019
-------------------------	-----------------	--------------	---------------------

DRAWING NO: <b>EN020022-ES-24.2-Sheet3</b>	REV.NO. 01
---	---------------

Reproduced from Ordnance Survey digital map data © Crown copyright [date]. All rights reserved. Licence number [add number].  
© Crown copyright material is reproduced with the permission of Land Registry under delegated authority from the Controller of HMSO. This material was last updated in [date] and may not be copied, distributed, sold or published without the formal permission of Land Registry. Only an official copy of a title plan or register obtained from the Land Registry may be used for legal or other official purposes.  
May contain public sector information licensed under the Open Government Licence v 3.0.



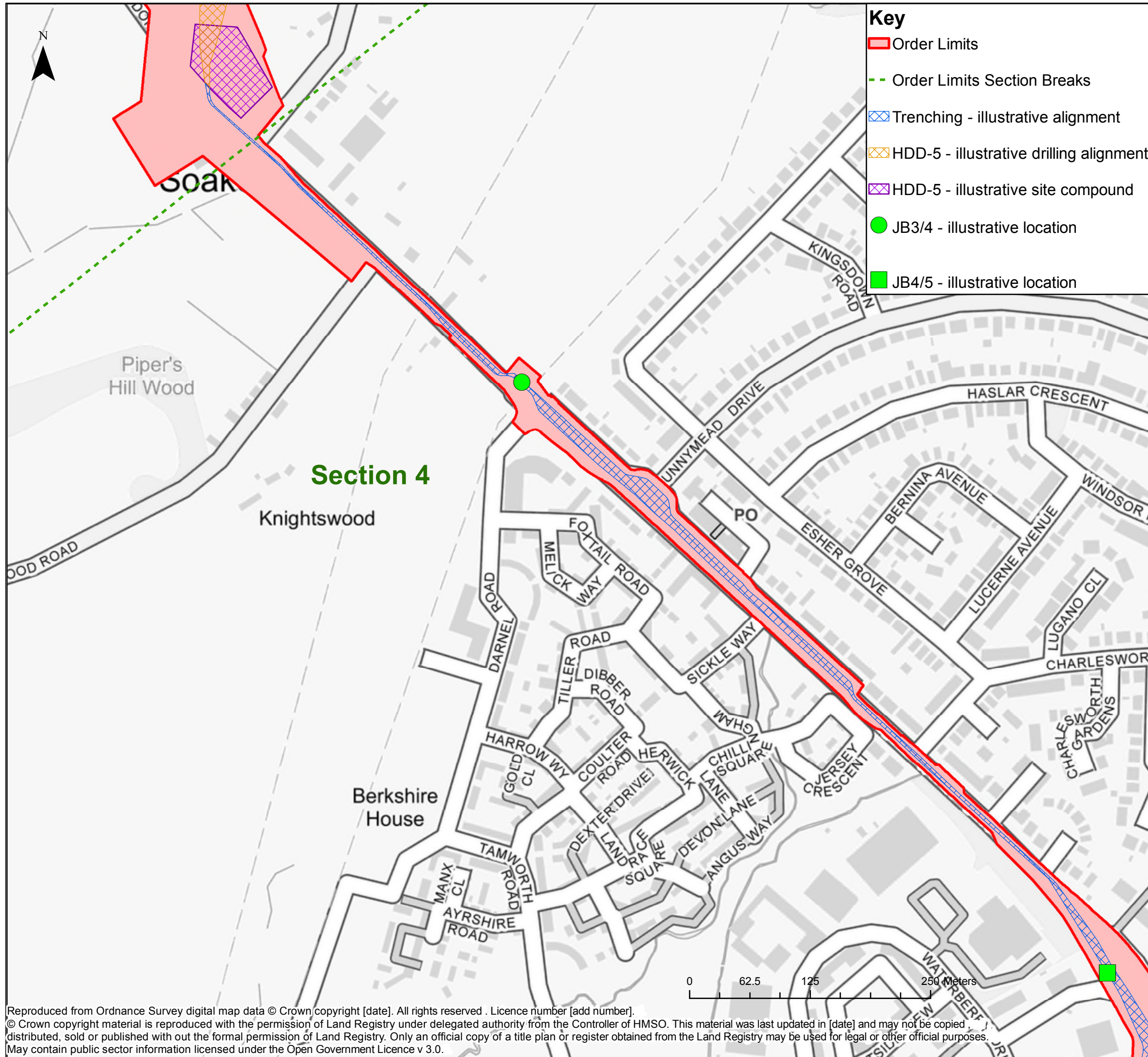

**Key**

- Order Limits
- Order Limits Section Breaks
- Trenching - illustrative alignment
- HDD-5 - illustrative drilling alignment
- HDD-5 - illustrative site compound
- JB3/4 - illustrative location
- JB4/5 - illustrative location

**N.B. The trenching, HDD and joint bay locations/alignments are for illustrative purposes only to provide context to the noise and vibration assessment. The illustration represents a scenario of how the cable route could be laid within the cable corridor, to facilitate a reasonable worst case noise and vibration assessment. The precise alignment and locations of the cable route, HDD sites and joint bays are yet to be determined.**

The Infrastructure Planning (Applications: Prescribed Forms and Procedure) Regulations 2009 – Regulation 5(2)(a)

01	24/10/2019	YH	FIRST ISSUE	TF	LB
REV	DATE	BY	DESCRIPTION	CHK	APP

DRAWING STATUS: FINAL



WSP House, 70 Chancery Lane, London, WC2A 1AF, UK,  
T+ 44 (0) 020 7314 5000  
wsp.com



PROJECT: AQUIND Interconnector

TITLE: Low Resolution - Figure 24.2  
Illustrative cable route, HDD sites and joint bays for noise and vibration assessment  
Sheet 4 of 15

SCALE AT A3 1:3,950	CHECKED: TF	APPROVED: LB
------------------------	----------------	-----------------

PROJECT NO: EN020022	DESIGNED: TF	DRAWN: YH	DATE: 24/10/2019
-------------------------	-----------------	--------------	---------------------

DRAWING NO: EN020022-ES-24.2-Sheet4	REV.NO: 01
--	---------------

Reproduced from Ordnance Survey digital map data © Crown copyright [date]. All rights reserved . Licence number [add number].  
© Crown copyright material is reproduced with the permission of Land Registry under delegated authority from the Controller of HMSO. This material was last updated in [date] and may not be copied, distributed, sold or published with out the formal permission of Land Registry. Only an official copy of a title plan or register obtained from the Land Registry may be used for legal or other official purposes.  
May contain public sector information licensed under the Open Government Licence v 3.0.



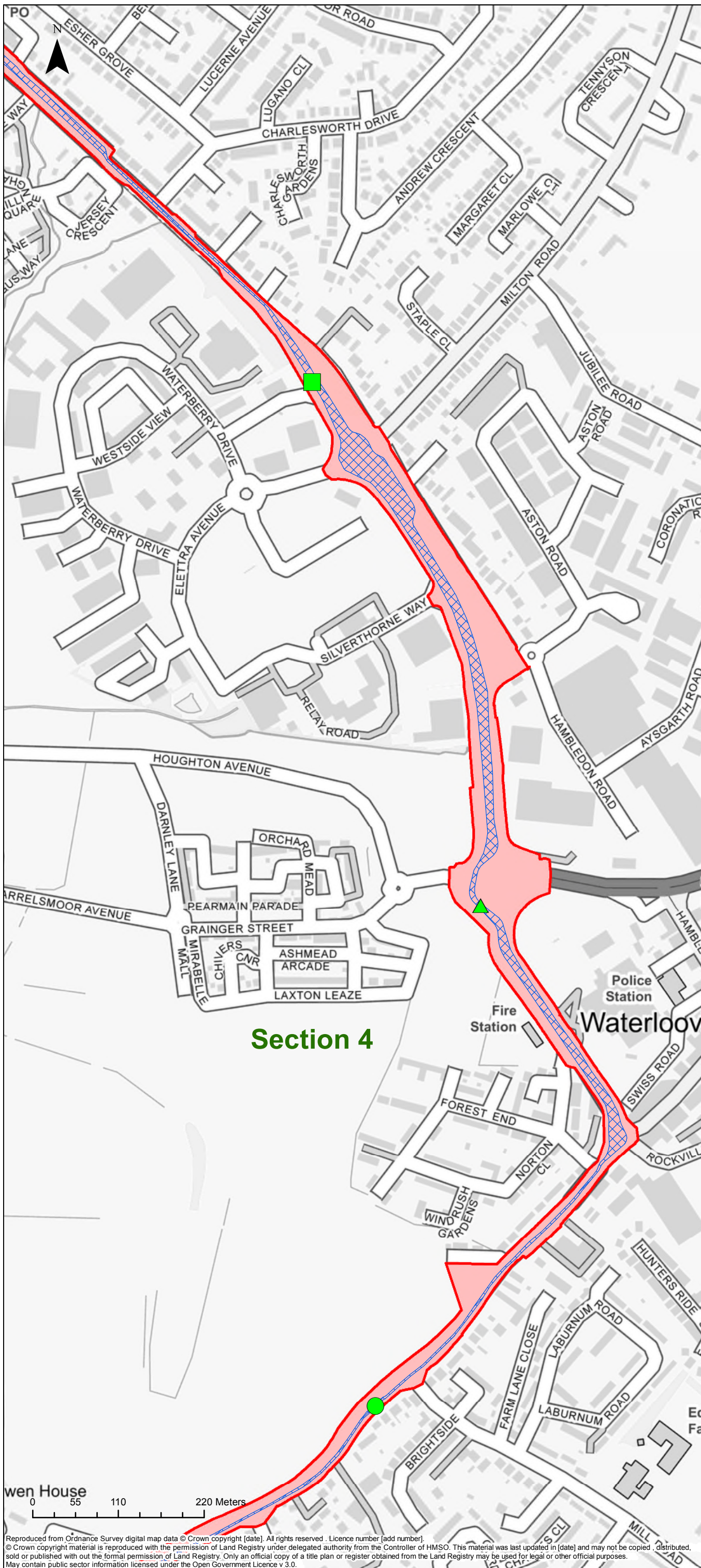

### Key

- Order Limits
- Trenching - illustrative alignment
- JB4/5 - illustrative location
- JB5/6 - illustrative location
- JB6/7 - illustrative location

**N.B. The trenching, HDD and joint bay locations/alignments are for illustrative purposes only to provide context to the noise and vibration assessment. The illustration represents a scenario of how the cable route could be laid within the cable corridor, to facilitate a reasonable worst case noise and vibration assessment. The precise alignment and locations of the cable route, HDD sites and joint bays are yet to be determined.**

The Infrastructure Planning (Applications: Prescribed Forms and Procedure) Regulations 2009 – Regulation 5(2)(a)

REV	DATE	BY	DESCRIPTION	CHK	APP
01	24/10/2019	YH	FIRST ISSUE	TF	LB

DRAWING STATUS: **FINAL**



WSP House, 70 Chancery Lane, London, WC2A 1AF,  
T+ 44 (0) 20 7314 5000  
wsp.com

CLIENT:



PROJECT:  
**AQUIND Interconnector**

TITLE:  
Low Resolution - Figure 24.2  
Illustrative cable route, HDD sites and  
joint bays for noise and vibration assessment  
Sheet 5 of 15

SCALE AT A1 1:5,030	CHECKED: TF	APPROVED: LB
PROJECT NO: EN020022	DESIGNED: TF	DRAWN: YH
	DATE: 23/10/2019	

DRAWING NO: <b>EN020022-ES-24.2-Sheet5</b>	REV.NO. 01
---	---------------

© WSP UK Ltd

Reproduced from Ordnance Survey digital map data © Crown copyright [date]. All rights reserved. Licence number [add number].  
© Crown copyright material is reproduced with the permission of Land Registry under delegated authority from the Controller of HMSO. This material was last updated in [date] and may not be copied, distributed, sold or published without the formal permission of Land Registry. Only an official copy of a title plan or register obtained from the Land Registry may be used for legal or other official purposes.  
May contain public sector information licensed under the Open Government Licence v 3.0.



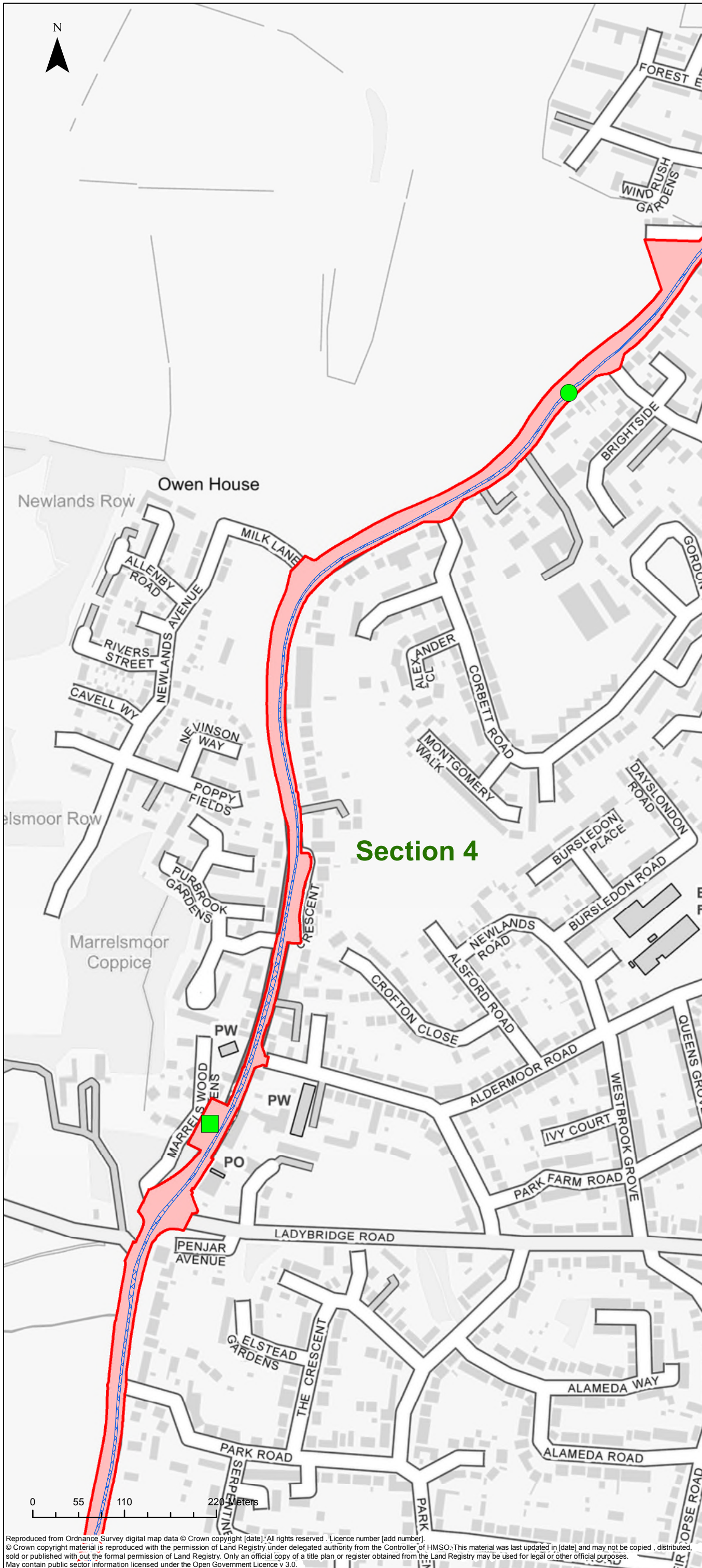

### Key

- Order Limits
- Trenching - illustrative alignment
- JB6/7 - illustrative location
- JB7/8 - illustrative location

**N.B. The trenching, HDD and joint bay locations/alignments are for illustrative purposes only to provide context to the noise and vibration assessment. The illustration represents a scenario of how the cable route could be laid within the cable corridor, to facilitate a reasonable worst case noise and vibration assessment. The precise alignment and locations of the cable route, HDD sites and joint bays are yet to be determined.**

The Infrastructure Planning (Applications: Prescribed Forms and Procedure) Regulations 2009 – Regulation 5(2)(a)

REV	DATE	BY	DESCRIPTION	CHK	APP
01	24/10/2019	YH	FIRST ISSUE	TF	LB

DRAWING STATUS: **FINAL**



WSP House, 70 Chancery Lane, London, WC2A 1AF,  
T+ 44 (0) 020 7314 5000  
wsp.com

CLIENT:



PROJECT: **AQUIND Interconnector**

TITLE: **Low Resolution - Figure 24.2  
Illustrative cable route, HDD sites and  
joint bays for noise and vibration assessment  
Sheet 6 of 15**

SCALE AT A1 1:4,700	CHECKED: TF	APPROVED: LB
PROJECT NO: EN020022	DESIGNED: TF	DRAWN: YH
DRAWING NO: <b>EN020022-ES-24.2-Sheet6</b>		DATE: 23/10/2019

REV.NO. <b>01</b>
----------------------

Reproduced from Ordnance Survey digital map data © Crown copyright [date]. All rights reserved. Licence number [add number].  
© Crown copyright material is reproduced with the permission of Land Registry under delegated authority from the Controller of HMSO. This material was last updated in [date] and may not be copied, distributed, sold or published without the formal permission of Land Registry. Only an official copy of a title plan or register obtained from the Land Registry may be used for legal or other official purposes.  
May contain public sector information licensed under the Open Government Licence v 3.0.



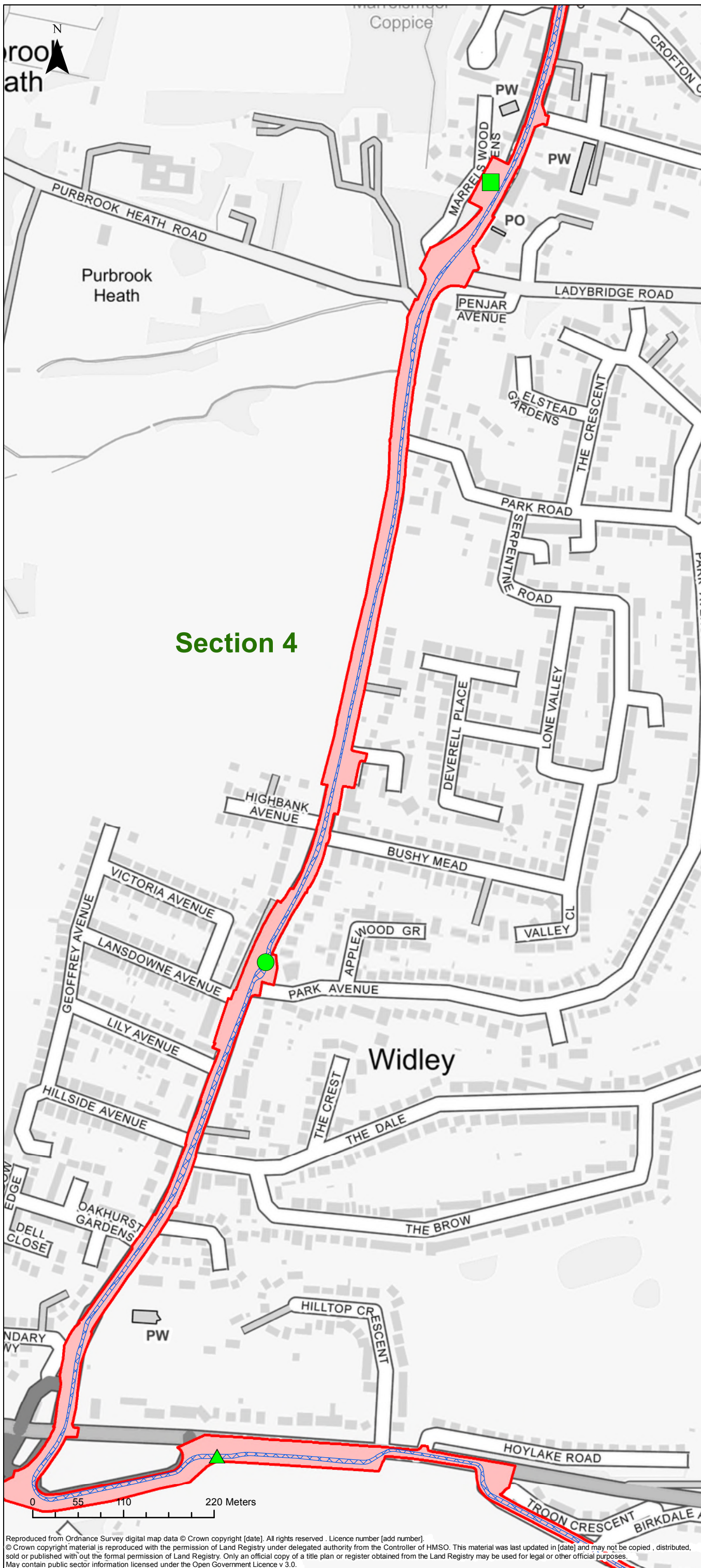

**Section 4**

**Key**

- Order Limits
- Trenching - illustrative alignment
- JB7/8 - illustrative location
- JB8/9 - illustrative location
- JB9/10 - illustrative location

**N.B. The trenching, HDD and joint bay locations/alignments are for illustrative purposes only to provide context to the noise and vibration assessment. The illustration represents a scenario of how the cable route could be laid within the cable corridor, to facilitate a reasonable worst case noise and vibration assessment. The precise alignment and locations of the cable route, HDD sites and joint bays are yet to be determined.**

The Infrastructure Planning (Applications: Prescribed Forms and Procedure) Regulations 2009 – Regulation 5(2)(a)

REV	DATE	BY	DESCRIPTION	CHK	APP
01	24/10/2019	YH	FIRST ISSUE	TF	LB

DRAWING STATUS: **FINAL**



WSP House, 70 Chancery Lane, London, WC2A 1AF,  
T+ 44 (0) 020 7314 5000  
wsp.com

CLIENT:



PROJECT:

**AQUIND Interconnector**

TITLE:

Low Resolution - Figure 24.2  
Illustrative cable route, HDD sites and  
joint bays for noise and vibration assessment  
Sheet 7 of 15

SCALE AT A1 1:4,750	CHECKED: TF	APPROVED: LB
PROJECT NO: EN020022	DESIGNED: TF	DRAWN: YH
	DATE: 23/10/2019	

DRAWING NO: <b>EN020022-ES-24.2-Sheet7</b>	REV.NO. 01
---	---------------

Reproduced from Ordnance Survey digital map data © Crown copyright [date]. All rights reserved. Licence number [add number].  
© Crown copyright material is reproduced with the permission of Land Registry under delegated authority from the Controller of HMSO. This material was last updated in [date] and may not be copied, distributed, sold or published without the formal permission of Land Registry. Only an official copy of a title plan or register obtained from the Land Registry may be used for legal or other official purposes.  
May contain public sector information licensed under the Open Government Licence v 3.0.



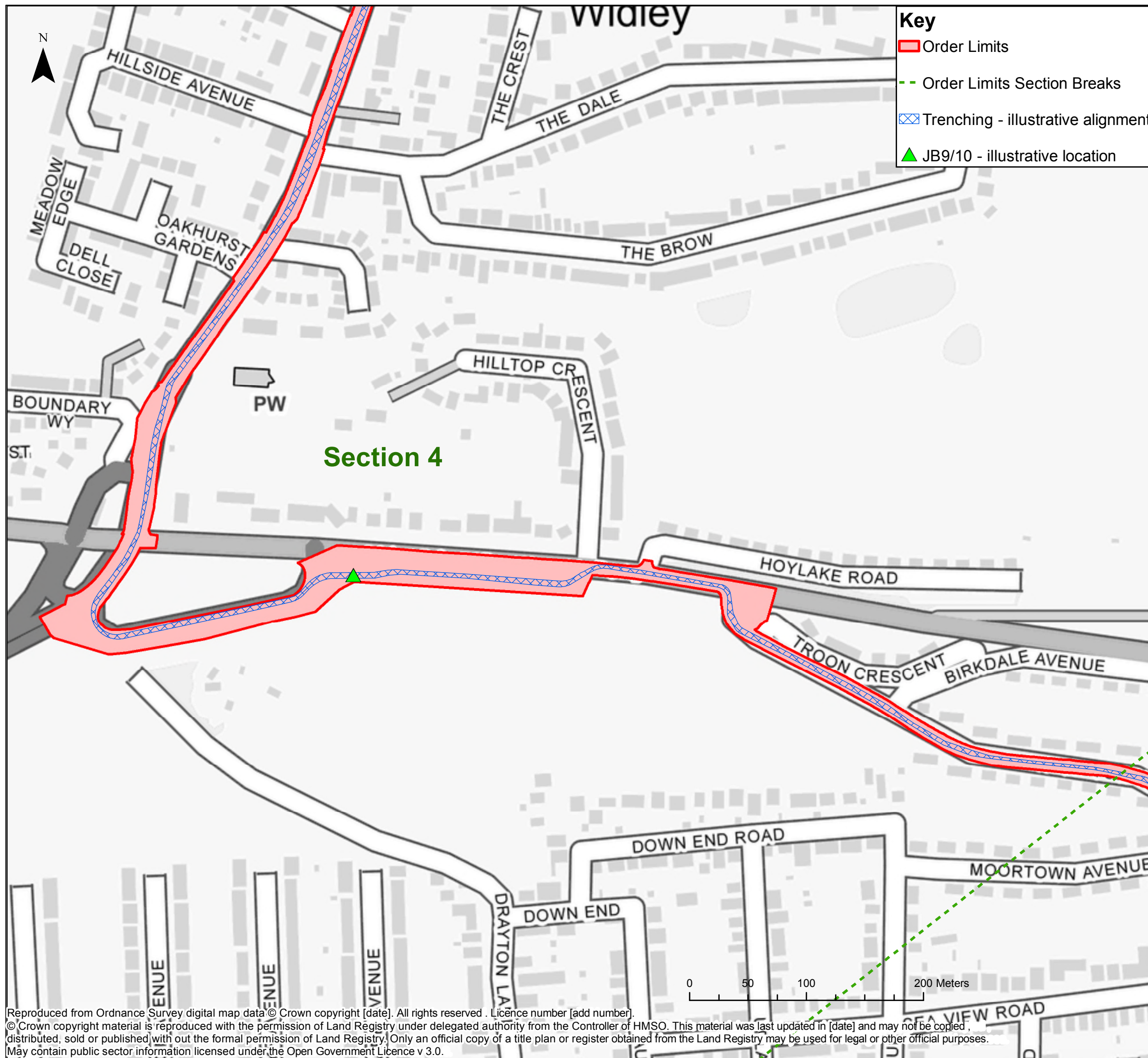

**Key**

- Order Limits
- Order Limits Section Breaks
- Trenching - illustrative alignment
- JB9/10 - illustrative location

**N.B. The trenching, HDD and joint bay locations/alignments are for illustrative purposes only to provide context to the noise and vibration assessment. The illustration represents a scenario of how the cable route could be laid within the cable corridor, to facilitate a reasonable worst case noise and vibration assessment. The precise alignment and locations of the cable route, HDD sites and joint bays are yet to be determined.**

The Infrastructure Planning (Applications: Prescribed Forms and Procedure) Regulations 2009 – Regulation 5(2)(a)

REV	DATE	BY	DESCRIPTION	CHK	APP
01	24/10/2019	YH	FIRST ISSUE	TF	LB

DRAWING STATUS: **FINAL**



WSP House, 70 Chancery Lane, London, WC2A 1AF, UK,  
T+ 44 (0) 020 7314 5000  
wsp.com

CLIENT:



PROJECT:  
**AQUIND Interconnector**

TITLE:  
**Low Resolution - Figure 24.2  
Illustrative cable route, HDD sites and  
joint bays for noise and vibration assessment  
Sheet 8 of 15**

SCALE AT A3 1:3,260	CHECKED: TF	APPROVED: LB
------------------------	----------------	-----------------

PROJECT NO: EN020022	DESIGNED: TF	DRAWN: YH	DATE: 24/10/2019
-------------------------	-----------------	--------------	---------------------

DRAWING NO: <b>EN020022-ES-24.2-Sheet8</b>	REV.NO: <b>01</b>
---	----------------------

Reproduced from Ordnance Survey digital map data © Crown copyright [date]. All rights reserved. Licence number [add number].  
© Crown copyright material is reproduced with the permission of Land Registry under delegated authority from the Controller of HMSO. This material was last updated in [date] and may not be copied, distributed, sold or published without the formal permission of Land Registry. Only an official copy of a title plan or register obtained from the Land Registry may be used for legal or other official purposes.  
May contain public sector information licensed under the Open Government Licence v 3.0.



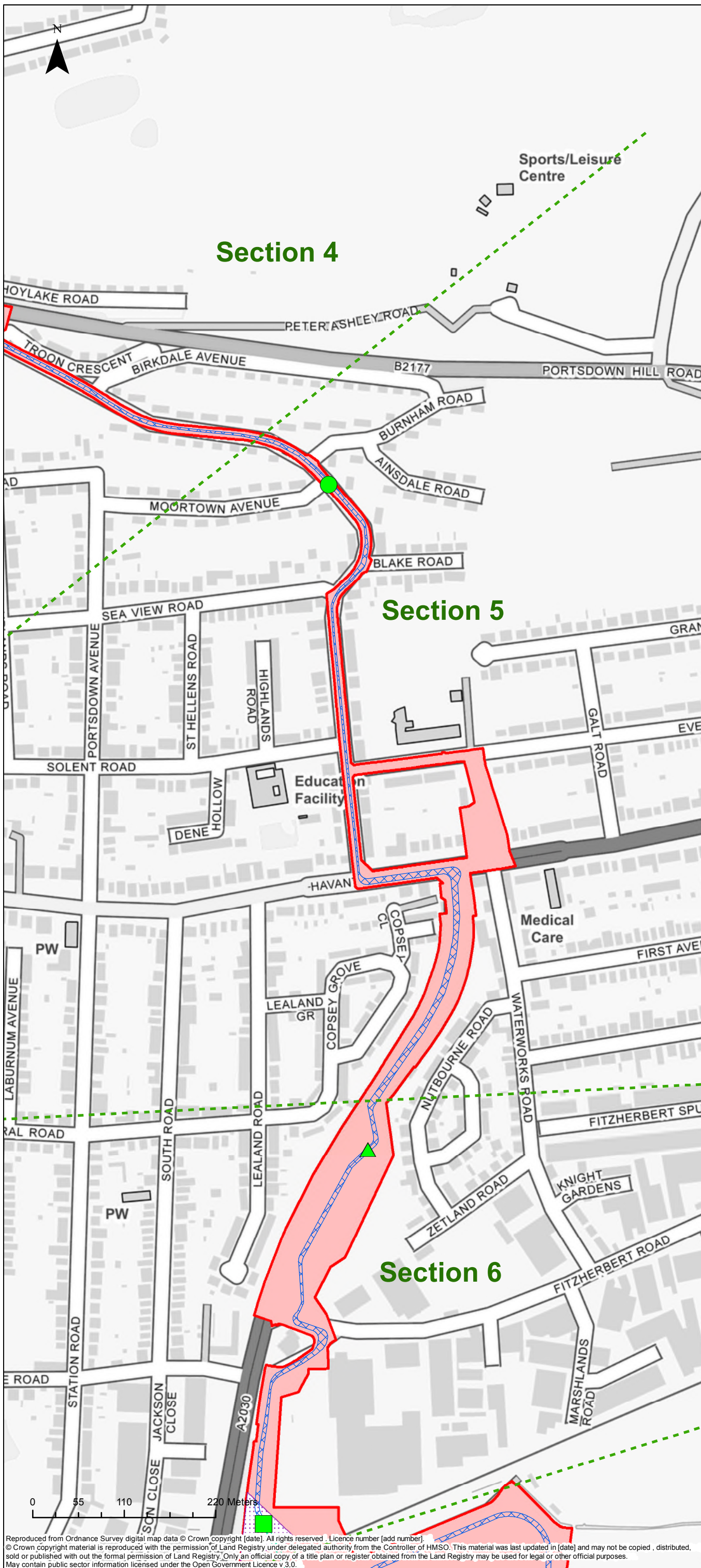

### Key

- Order Limits
- Order Limits Section Breaks
- Trenching - illustrative alignment
- HDD-4 - illustrative drilling alignment
- HDD-4 - reception pit - illustrative site compound
- JB10/11- illustrative location
- JB11/12- illustrative location
- JB12/13- illustrative location

**N.B. The trenching, HDD and joint bay locations/alignments are for illustrative purposes only to provide context to the noise and vibration assessment. The illustration represents a scenario of how the cable route could be laid within the cable corridor, to facilitate a reasonable worst case noise and vibration assessment. The precise alignment and locations of the cable route, HDD sites and joint bays are yet to be determined.**

The Infrastructure Planning (Applications: Prescribed Forms and Procedure) Regulations 2009 – Regulation 5(2)(a)

REV	DATE	BY	DESCRIPTION	CHK	APP
01	24/10/2019	YH	FIRST ISSUE	TF	LB

DRAWING STATUS: **FINAL**



WSP House, 70 Chancery Lane, London, WC2A 1AF,  
T+ 44 (0) 020 7314 5000  
wsp.com

CLIENT:



PROJECT:  
**AQUIND Interconnector**

TITLE:  
Low Resolution - Figure 24.2  
Illustrative cable route, HDD sites and  
joint bays for noise and vibration assessment  
Sheet 9 of 15

SCALE AT A1 1:4,710	CHECKED: TF	APPROVED: LB
PROJECT NO: EN020022	DESIGNED: TF	DRAWN: YH
	DATE: 23/10/2019	

DRAWING NO: <b>EN020022-ES-24.2-Sheet9</b>	REV.NO. 01
---	---------------

Reproduced from Ordnance Survey digital map data © Crown copyright [date]. All rights reserved. Licence number [add number].  
© Crown copyright material is reproduced with the permission of Land Registry under delegated authority from the Controller of HMSO. This material was last updated in [date] and may not be copied, distributed, sold or published without the formal permission of Land Registry. Only an official copy of a title plan or register obtained from the Land Registry may be used for legal or other official purposes.  
May contain public sector information licensed under the Open Government Licence v 3.0.



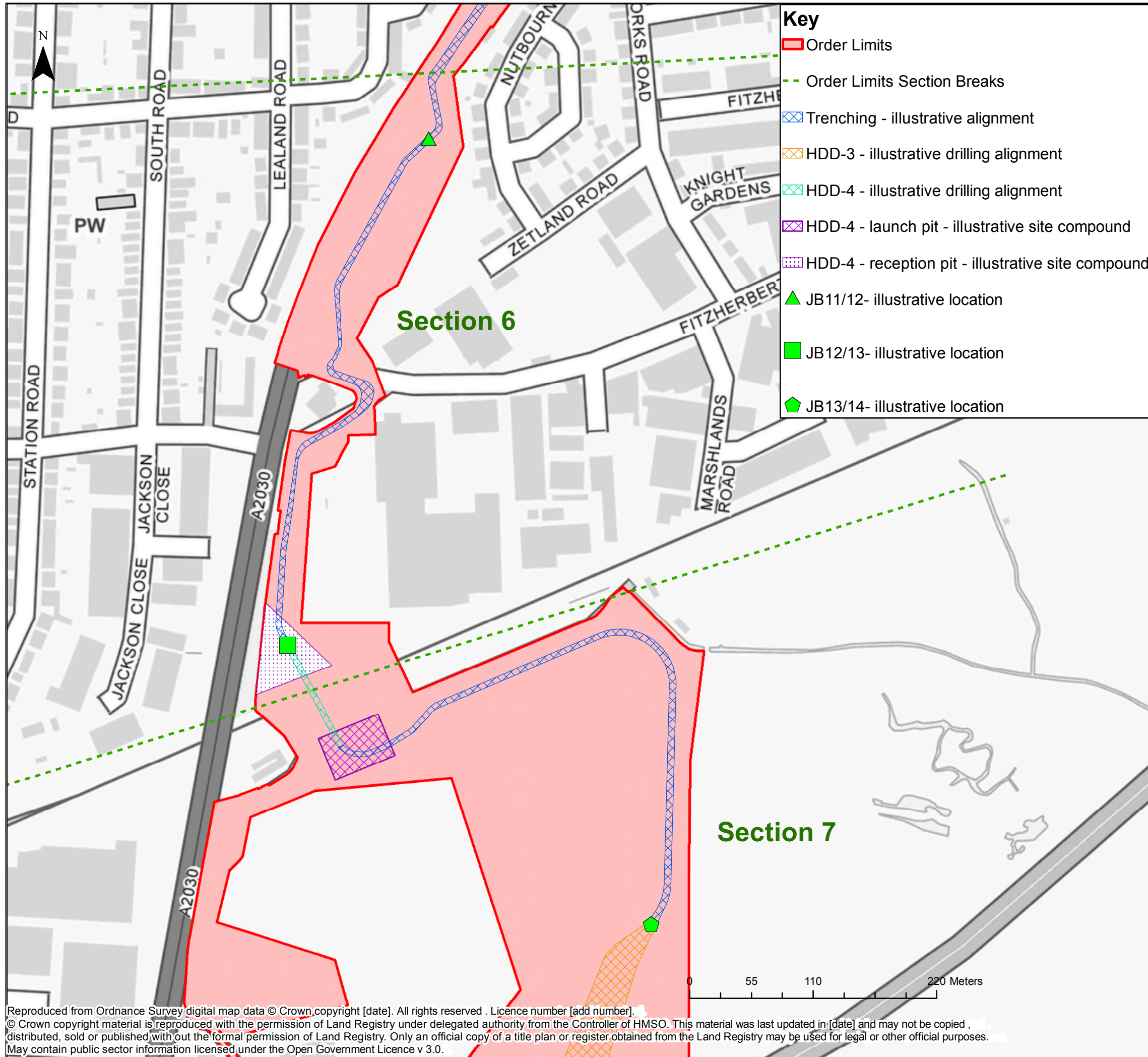

**Key**

- Order Limits
- Order Limits Section Breaks
- Trenching - illustrative alignment
- HDD-3 - illustrative drilling alignment
- HDD-4 - illustrative drilling alignment
- HDD-4 - launch pit - illustrative site compound
- HDD-4 - reception pit - illustrative site compound
- ▲ JB11/12- illustrative location
- JB12/13- illustrative location
- ◆ JB13/14- illustrative location

**N.B. The trenching, HDD and joint bay locations/alignments are for illustrative purposes only to provide context to the noise and vibration assessment. The illustration represents a scenario of how the cable route could be laid within the cable corridor, to facilitate a reasonable worst case noise and vibration assessment. The precise alignment and locations of the cable route, HDD sites and joint bays are yet to be determined.**

The Infrastructure Planning (Applications: Prescribed Forms and Procedure) Regulations 2009 – Regulation 5(2)(a)

01	24/10/2019	YH	FIRST ISSUE	TF	LB
REV	DATE	BY	DESCRIPTION	CHK	APP

DRAWING STATUS: **FINAL**



WSP House, 70 Chancery Lane, London, WC2A 1AF, UK,  
T+ 44 (0) 020 7314 5000  
wsp.com

CLIENT:



PROJECT:  
**AQUIND Interconnector**

TITLE:  
**Low Resolution - Figure 24.2  
Illustrative cable route, HDD sites and  
joint bays for noise and vibration assessment  
Sheet 10 of 15**

SCALE AT A3 1:3,390	CHECKED: TF	APPROVED: LB
------------------------	----------------	-----------------

PROJECT NO: EN020022	DESIGNED: TF	DRAWN: YH	DATE: 24/10/2019
-------------------------	-----------------	--------------	---------------------

DRAWING NO: <b>EN020022-ES-24.2-Sheet10</b>	REV.NO: <b>01</b>
--	----------------------

Reproduced from Ordnance Survey digital map data © Crown copyright [date]. All rights reserved. Licence number [add number].  
© Crown copyright material is reproduced with the permission of Land Registry under delegated authority from the Controller of HMSO. This material was last updated in [date] and may not be copied, distributed, sold or published without the formal permission of Land Registry. Only an official copy of a title plan or register obtained from the Land Registry may be used for legal or other official purposes.  
May contain public sector information licensed under the Open Government Licence v 3.0.



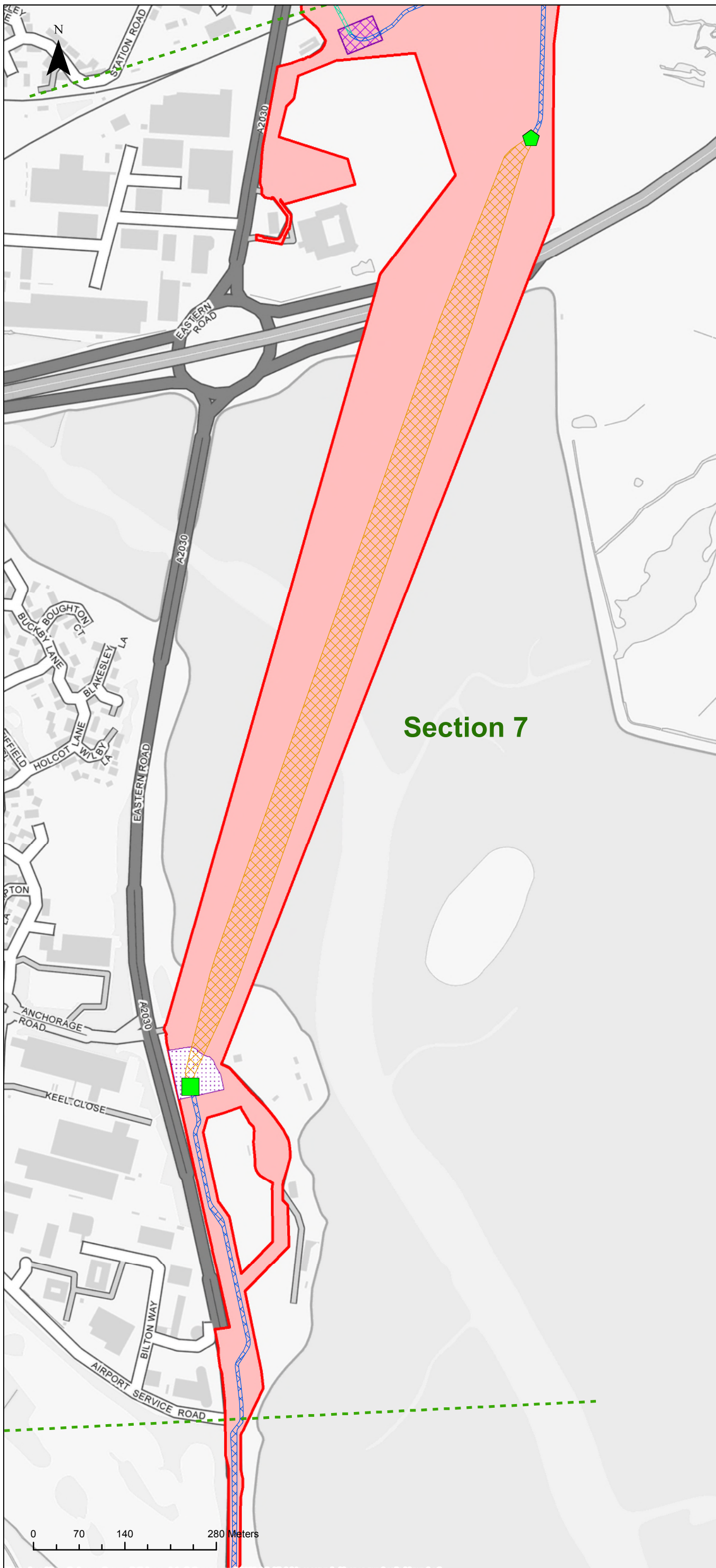

### Key

- Order Limits
- Order Limits Section Breaks
- Trenching - illustrative alignment
- HDD-3 - illustrative drilling alignment
- HDD-4 - illustrative drilling alignment
- HDD-3 - illustrative site compound
- HDD-4 - launch pit - illustrative site compound
- JB13/14- illustrative location
- JB14/15- illustrative location

**N.B. The trenching, HDD and joint bay locations/alignments are for illustrative purposes only to provide context to the noise and vibration assessment. The illustration represents a scenario of how the cable route could be laid within the cable corridor, to facilitate a reasonable worst case noise and vibration assessment. The precise alignment and locations of the cable route, HDD sites and joint bays are yet to be determined.**

The Infrastructure Planning (Applications: Prescribed Forms and Procedure) Regulations 2009 – Regulation 5(2)(a)

01	24/10/2019	YH	FIRST ISSUE	TF	LB
REV	DATE	BY	DESCRIPTION	CHK	APP

DRAWING STATUS: **FINAL**

WSP House, 70 Chancery Lane, London, WC2A 1AF,  
T+ 44 (0) 20 7314 5000  
wsp.com

CLIENT:

PROJECT:  
**AQUIND Interconnector**

TITLE:  
Low Resolution - Figure 24.2  
Illustrative cable route, HDD sites and  
joint bays for noise and vibration assessment  
Sheet 11 of 15

SCALE AT A1 1:6,130	CHECKED: TF	APPROVED: LB	
PROJECT NO: EN020022	DESIGNED: TF	DRAWN: YH	DATE: 23/10/2019

DRAWING NO: <b>EN020022-ES-24.2-Sheet11</b>	REV.NO. 01
--	---------------

Reproduced from Ordnance Survey digital map data © Crown copyright [date]. All rights reserved. Licence number [add number].  
© Crown copyright material is reproduced with the permission of Land Registry under delegated authority from the Controller of HMSO. This material was last updated in [date] and may not be copied, distributed, sold or published without the formal permission of Land Registry. Only an official copy of a title plan or register obtained from the Land Registry may be used for legal or other official purposes.  
May contain public sector information licensed under the Open Government Licence v 3.0.



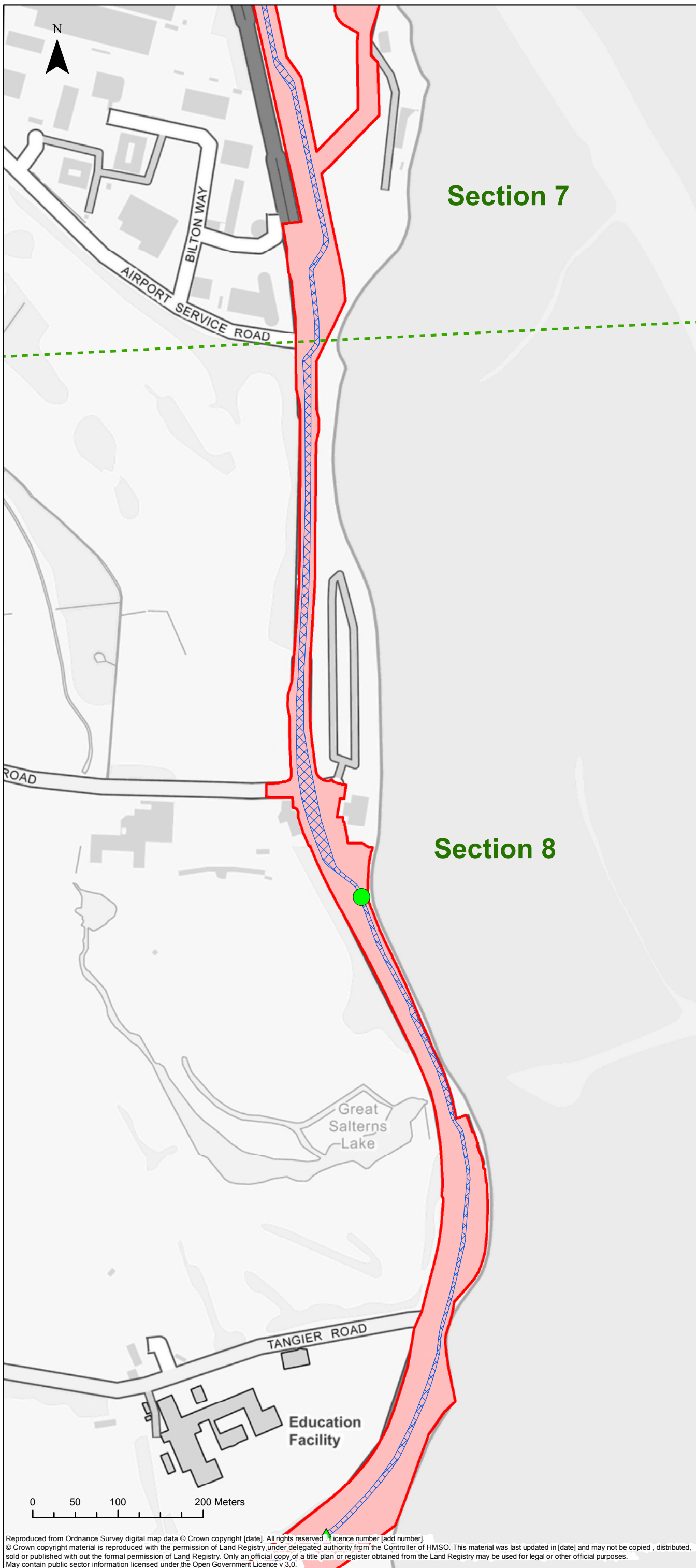

### Key

- Order Limits
- Order Limits Section Breaks
- Trenching - illustrative alignment
- JB15/16- illustrative location
- JB16/17 - illustrative location

**N.B. The trenching, HDD and joint bay locations/alignments are for illustrative purposes only to provide context to the noise and vibration assessment. The illustration represents a scenario of how the cable route could be laid within the cable corridor, to facilitate a reasonable worst case noise and vibration assessment. The precise alignment and locations of the cable route, HDD sites and joint bays are yet to be determined.**

The Infrastructure Planning (Applications: Prescribed Forms and Procedure) Regulations 2009 – Regulation 5(2)(a)

01	24/10/2019	YH	FIRST ISSUE	TF	LB
REV	DATE	BY	DESCRIPTION	CHK	APP

DRAWING STATUS: **FINAL**

WSP House, 70 Chancery Lane, London, WC2A 1AF,  
T+ 44 (0) 020 7314 5000  
wsp.com

CLIENT:

PROJECT:  
**AQUIND Interconnector**

TITLE:  
Low Resolution - Figure 24.2  
Illustrative cable route, HDD sites and  
joint bays for noise and vibration assessment  
Sheet 12 of 15

SCALE AT A1 1:4,600	CHECKED: TF	APPROVED: LB	
PROJECT NO: EN020022	DESIGNED: TF	DRAWN: YH	DATE: 23/10/2019

DRAWING NO: <b>EN020022-ES-24.2-Sheet12</b>	REV.NO. 01
--	---------------

Reproduced from Ordnance Survey digital map data © Crown copyright [date]. All rights reserved. Licence number [add number].  
© Crown copyright material is reproduced with the permission of Land Registry under delegated authority from the Controller of HMSO. This material was last updated in [date] and may not be copied, distributed, sold or published without the formal permission of Land Registry. Only an official copy of a title plan or register obtained from the Land Registry may be used for legal or other official purposes.  
May contain public sector information licensed under the Open Government Licence v 3.0.



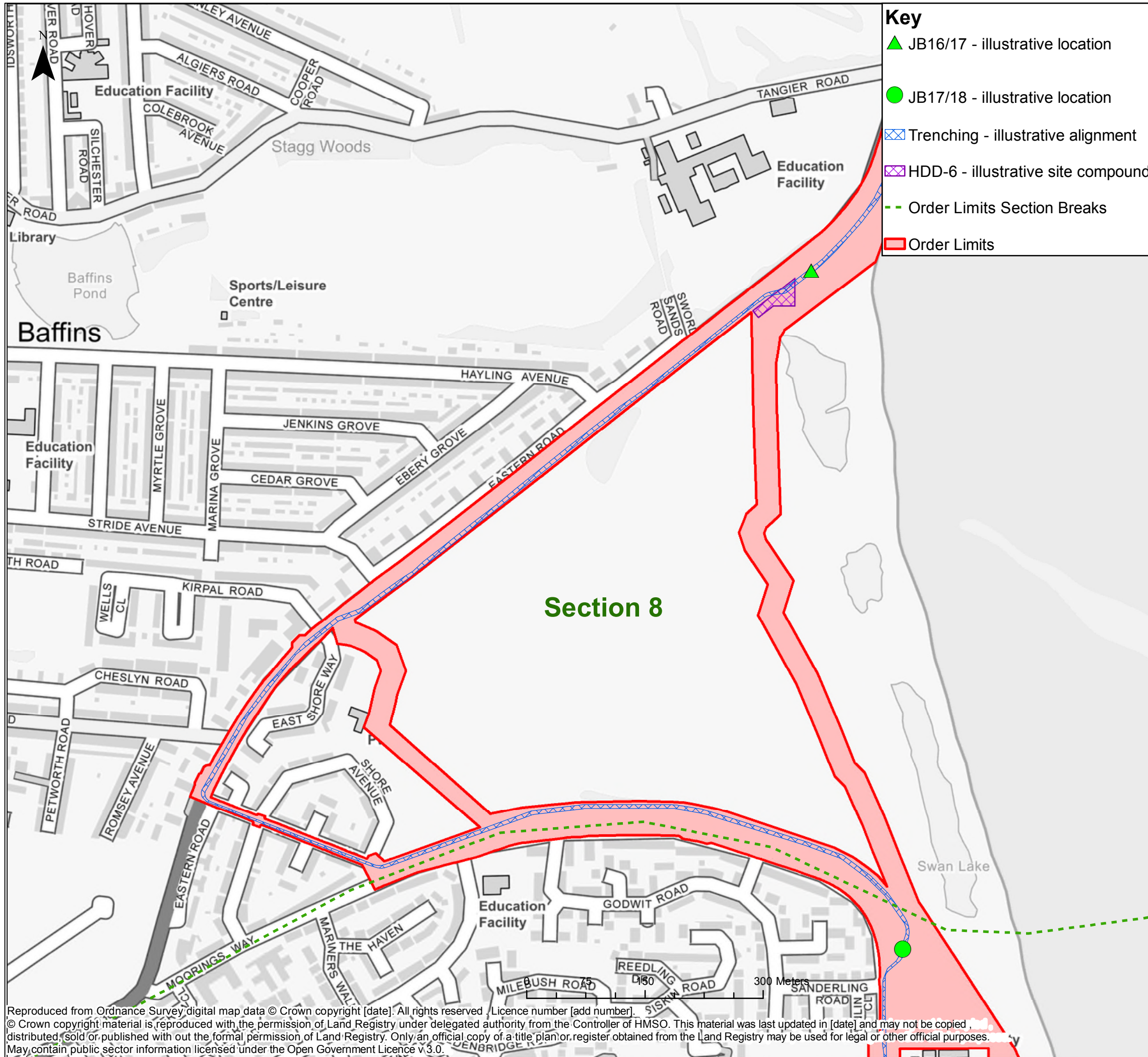

**N.B. The trenching, HDD and joint bay locations/alignments are for illustrative purposes only to provide context to the noise and vibration assessment. The illustration represents a scenario of how the cable route could be laid within the cable corridor, to facilitate a reasonable worst case noise and vibration assessment. The precise alignment and locations of the cable route, HDD sites and joint bays are yet to be determined.**

REV	DATE	BY	DESCRIPTION	CHK	APP
01	24/10/2019	YH	FIRST ISSUE	TF	LB

DRAWING STATUS: **FINAL**

**wsp**

WSP House, 70 Chancery Lane, London, WC2A 1AF, UK,  
T+ 44 (0) 020 7314 5000  
wsp.com

CLIENT:

**AQUIND**

PROJECT:

AQUIND Interconnector

TITLE:

Low Resolution - Figure 24.2  
Illustrative cable route, HDD sites and  
joint bays for noise and vibration assessment  
Sheet 13 of 15

SCALE AT A3 1:4,830	CHECKED: TF	APPROVED: LB
------------------------	----------------	-----------------

PROJECT NO: EN020022	DESIGNED: TF	DRAWN: YH	DATE: 05/11/2019
-------------------------	-----------------	--------------	---------------------

DRAWING NO: <b>EN020022-ES-24.2-Sheet13</b>	REV.NO: <b>01</b>
--	----------------------

© WSP UK Ltd

Reproduced from Ordnance Survey digital map data © Crown copyright [date]. All rights reserved. Licence number [add number].  
© Crown copyright material is reproduced with the permission of Land Registry under delegated authority from the Controller of HMSO. This material was last updated in [date] and may not be copied, distributed, sold or published without the formal permission of Land Registry. Only an official copy of a title plan or register obtained from the Land Registry may be used for legal or other official purposes.  
May contain public sector information licensed under the Open Government Licence v.3.0.



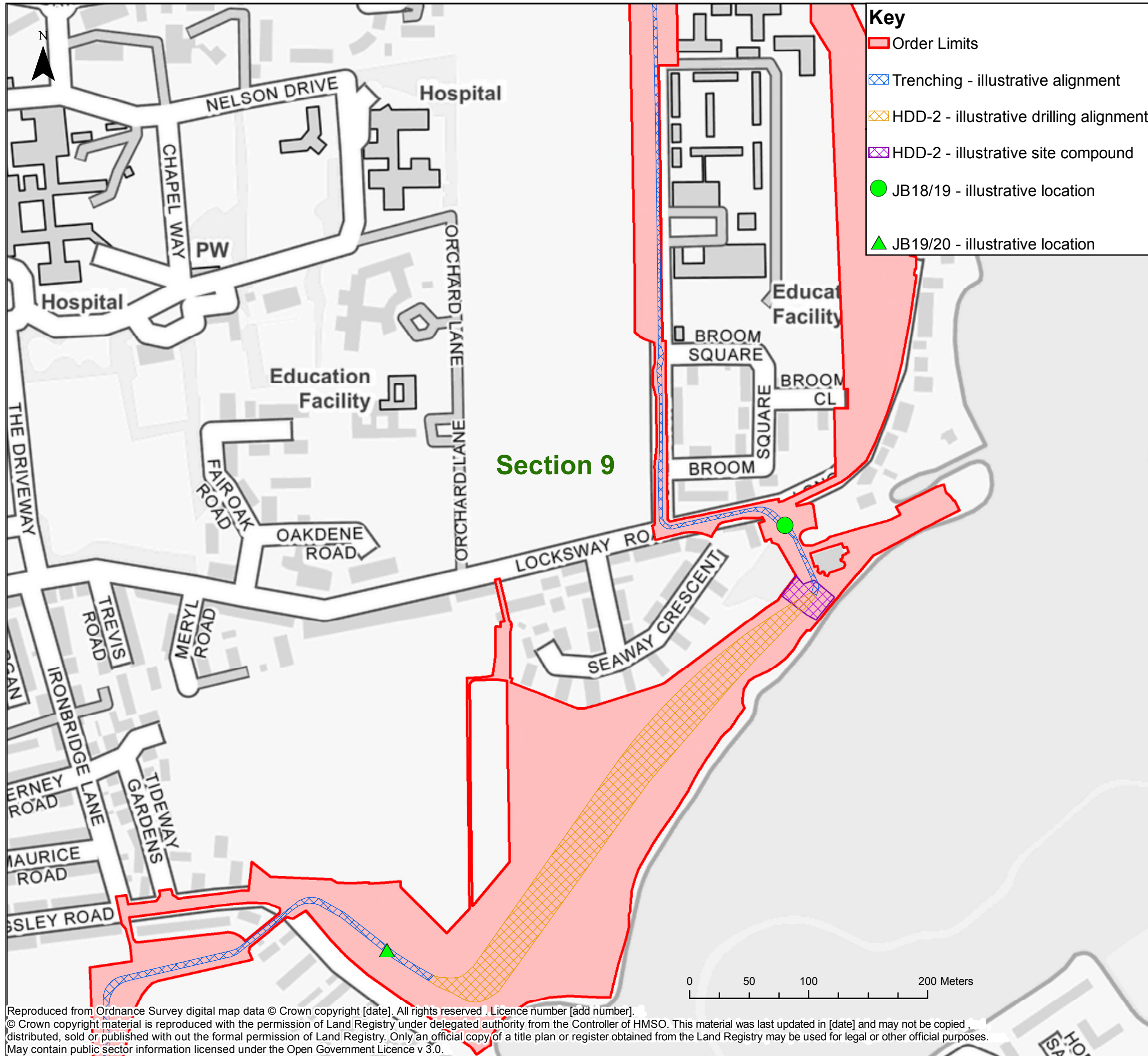

**Key**

- Order Limits
- Trenching - illustrative alignment
- HDD-2 - illustrative drilling alignment
- HDD-2 - illustrative site compound
- JB18/19 - illustrative location
- ▲ JB19/20 - illustrative location

**N.B. The trenching, HDD and joint bay locations/alignments are for illustrative purposes only to provide context to the noise and vibration assessment. The illustration represents a scenario of how the cable route could be laid within the cable corridor, to facilitate a reasonable worst case noise and vibration assessment. The precise alignment and locations of the cable route, HDD sites and joint bays are yet to be determined.**

The Infrastructure Planning (Applications: Prescribed Forms and Procedure) Regulations 2009 – Regulation 5(2)(a)

REV	DATE	BY	DESCRIPTION	CHK	APP
01	24/10/2019	YH	FIRST ISSUE	TF	LB

DRAWING STATUS: **FINAL**



WSP House, 70 Chancery Lane, London, WC2A 1AF, UK,  
T+ 44 (0) 020 7314 5000  
wsp.com

CLIENT:



PROJECT:  
**AQUIND Interconnector**

TITLE:  
**Low Resolution - Figure 24.2  
Illustrative cable route, HDD sites and  
joint bays for noise and vibration assessment  
Sheet 14 of 15**

SCALE AT A3 1:3,200	CHECKED: TF	APPROVED: LB
------------------------	----------------	-----------------

PROJECT NO: EN020022	DESIGNED: TF	DRAWN: YH	DATE: 24/10/2019
-------------------------	-----------------	--------------	---------------------

DRAWING NO: <b>EN020022-ES-24.2-Sheet14</b>	REV.NO: <b>01</b>
--	----------------------

Reproduced from Ordnance Survey digital map data © Crown copyright [date]. All rights reserved. Licence number [add number].  
© Crown copyright material is reproduced with the permission of Land Registry under delegated authority from the Controller of HMSO. This material was last updated in [date] and may not be copied, distributed, sold or published without the formal permission of Land Registry. Only an official copy of a title plan or register obtained from the Land Registry may be used for legal or other official purposes.  
May contain public sector information licensed under the Open Government Licence v 3.0.



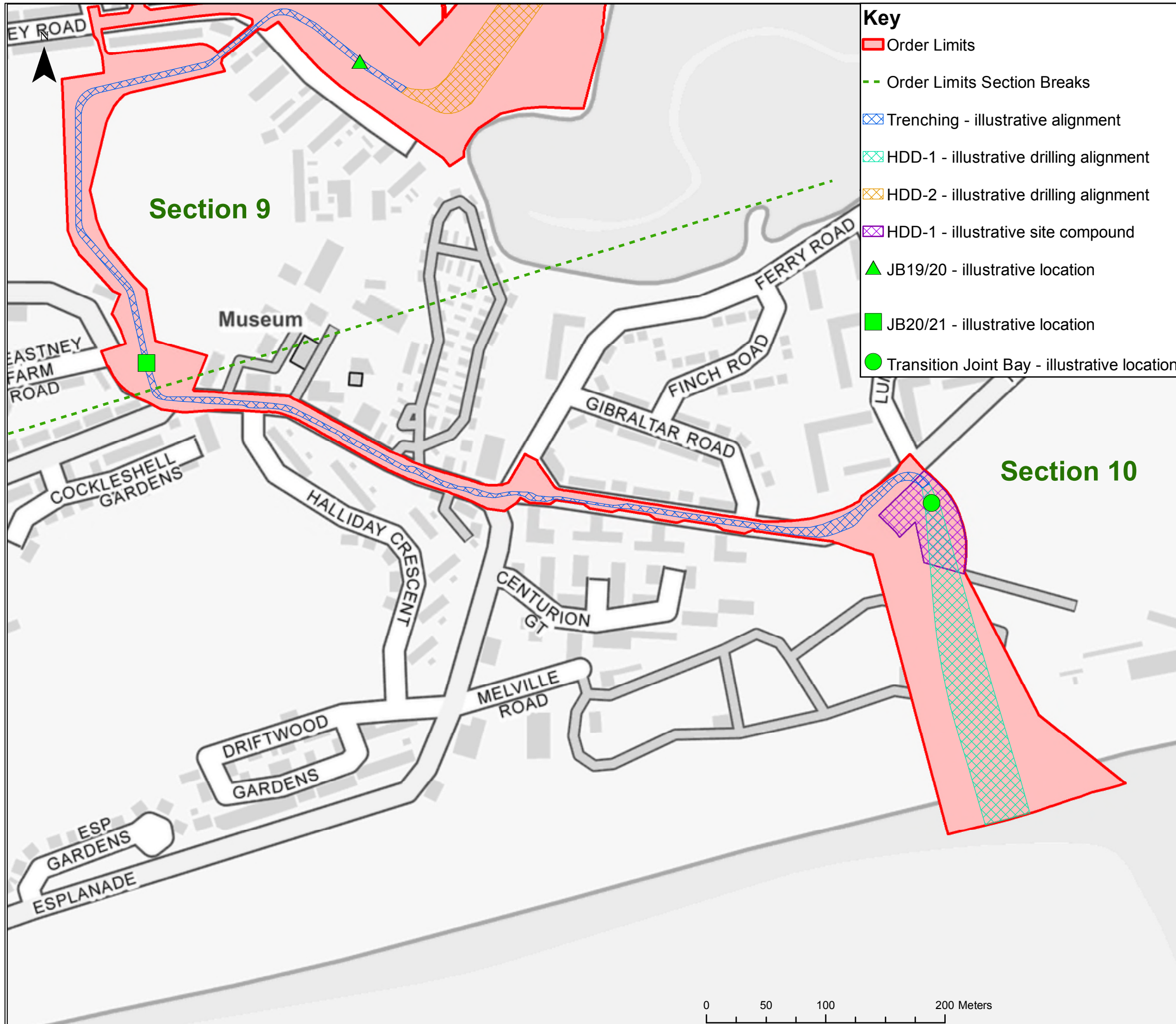

**Key**

- Order Limits
- Order Limits Section Breaks
- Trenching - illustrative alignment
- HDD-1 - illustrative drilling alignment
- HDD-2 - illustrative drilling alignment
- HDD-1 - illustrative site compound
- ▲ JB19/20 - illustrative location
- JB20/21 - illustrative location
- Transition Joint Bay - illustrative location

**N.B. The trenching, HDD and joint bay locations/alignments are for illustrative purposes only to provide context to the noise and vibration assessment. The illustration represents a scenario of how the cable route could be laid within the cable corridor, to facilitate a reasonable worst case noise and vibration assessment. The precise alignment and locations of the cable route, HDD sites and joint bays are yet to be determined.**

01	24/10/2019	YH	FIRST ISSUE	TF	LB
REV	DATE	BY	DESCRIPTION	CHK	APP

DRAWING STATUS: **FINAL**

**wsp**

WSP House, 70 Chancery Lane, London, WC2A 1AF, UK,  
T+ 44 (0) 020 7314 5000  
wsp.com

CLIENT:

**AQUIND**

PROJECT:

AQUIND Interconnector

TITLE:

Low Resolution - Figure 24.2  
Illustrative cable route, HDD sites and  
joint bays for noise and vibration assessment  
Sheet 15 of 15

SCALE AT A3 1:3,270	CHECKED: TF	APPROVED: LB	
------------------------	----------------	-----------------	--

PROJECT NO: EN020022	DESIGNED: TF	DRAWN: YH	DATE: 28/10/2019
-------------------------	-----------------	--------------	---------------------

DRAWING NO: <b>EN020022-ES-24.2-Sheet15</b>	REV.NO: <b>01</b>
--	----------------------

Reproduced from Ordnance Survey digital map data © Crown copyright [date]. All rights reserved . Licence number [add number].  
© Crown copyright material is reproduced with the permission of Land Registry under delegated authority from the Controller of HMSO. This material was last updated in [date] and may not be copied, distributed, sold or published with out the formal permission of Land Registry. Only an official copy of a title plan or register obtained from the Land Registry may be used for legal or other official purposes.  
May contain public sector information licensed under the Open Government Licence v 3.0.